

BM 1360://HBMD Administration Building Renovation and Expansion/2022\_104\_HBMD EXPANSION\_A\_R20\_LeAnneMJPY1C.v1

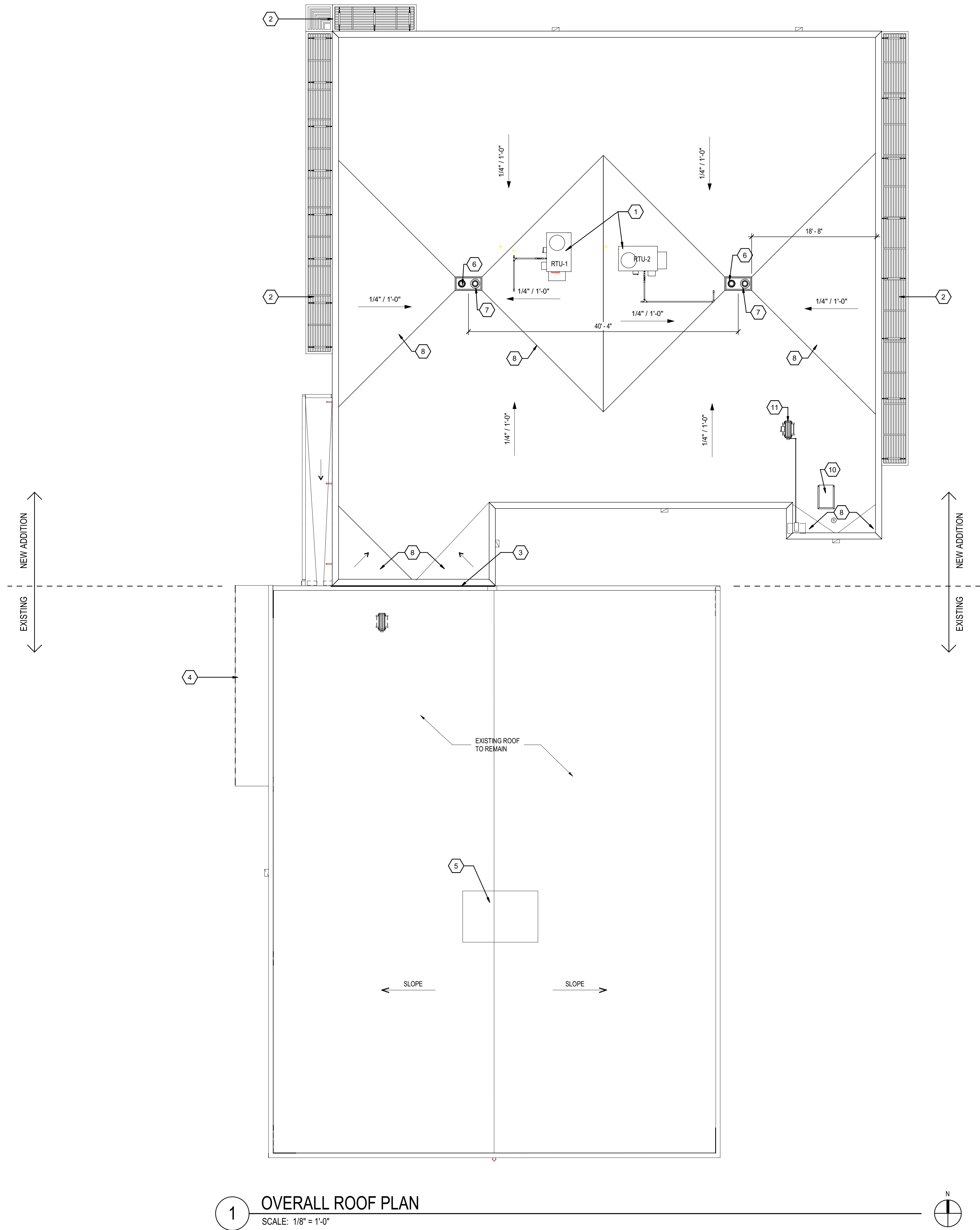

ROOF PLAN KEY NOTES	
1	ROOF TOP AIR CONDITIONING UNIT. REFER TO MECHANICAL DRAWINGS
2	NEW SUNSHADE SYSTEM
3	BUILDING EXPANSION JOINT. SEE STRUCTURAL DRAWINGS FOR DETAILS
4	PRE-MANUFACTURED, PRE-ENGINEERED ALUMINUM CANOPY BY SPECIALTY ENGINEER
5	EXISTING RTU TO REMAIN
6	ROOF DRAIN
7	OVERFLOW ROOF DRAIN
8	PROVIDE ROOF AS REQUIRED FOR POSITIVE DRAINAGE TOWARDS ROOF DRAIN, TYP.
9	TPO ROOFING SYSTEM ON RIGID POLY-ISO INSULATION.
10	ROOF ACCESS HATCH. BILCO S-50 ALUM, 30"x36", NOA NO. 19-1029-10, +/- 100 PSF
11	CONDENSING UNIT ON METAL STAND, REFER TO MECHANICAL DRAWINGS

**SALTZ MICHELSON**  
ARCHITECTS

3501 Griffin Road  
Ft. Lauderdale, FL 33312  
(954) 266-2700 Fx:(954) 266-2701  
sma@saltzmichelson.com

**DRC SUBMITTAL**  
**HBMD ADMIN BUILDING EXPANSION**  
**BROWARD COUNTY**  
1600 BLOUNT RD  
POMPANO BEACH FL 33069

Project No. :  
2022-104  
Drawn By :  
LE  
Checked By :  
CW  
Date:  
06.26.2023  
REVISIONS

**DRC**  
PZ23-10000012  
08/16/2023